

FRONT VIEW

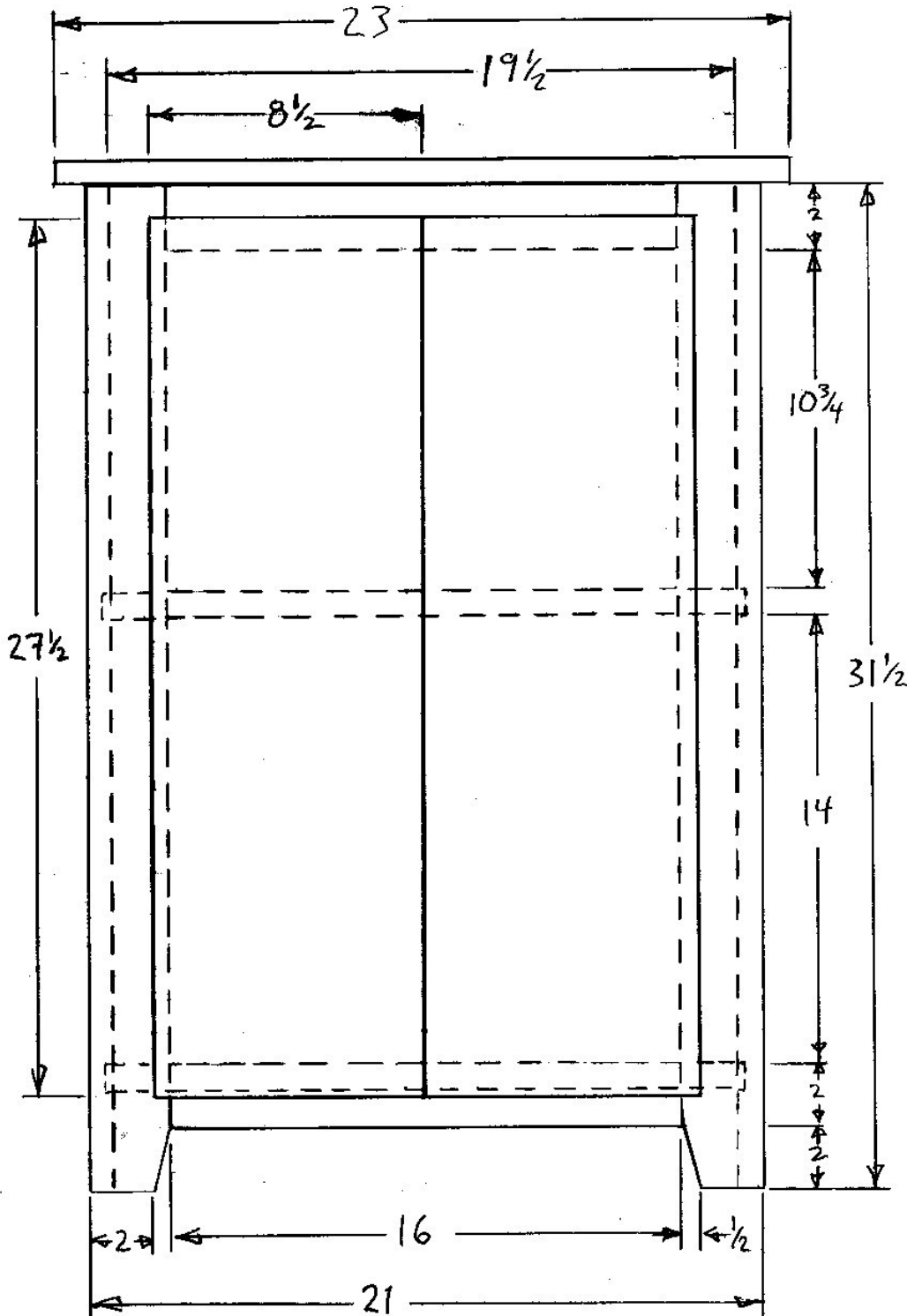

SIDE VIEW

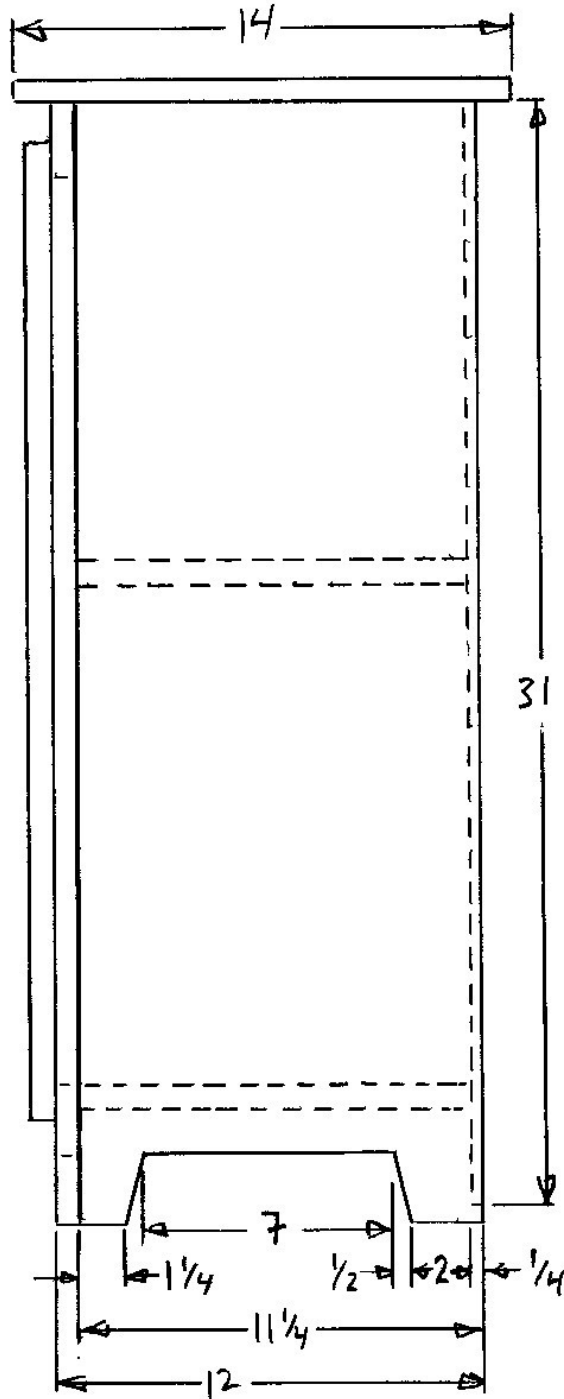

B.O.M.

		<u>BF</u>
(1)	14 X 23 TOP	2.24
(2)	3 1/2 X 2 1/2 FRONT STILE	1.09
(2)	16 X 2 FRONT RAIL	0.44
(2)	11 X 20 SHELF	3.06
(2)	8 1/2 X 27 1/2 DOOR	3.25
(2)	11 1/4 X 31 1/2 SIDE PANEL	4.92
		<u>15.00</u>

- (1) 20 X 31 X 1/4 PLY BACK
- (2) MISSION-STYLE CABINET PULL
- (4) OVERLAY HINGE

